

| | | | | | |
|--|------------------------|--|---------|---------------------------------------|------------------------------|
| Date Executed / Revised: | | RTD Railroad Utility Agreement - Application Data Sheet (Complete ALL Sections of this form) | | | RTD Agreement Number: |
| RTD Rail Route: | Nearest Cross-Streets: | City: | County: | ROW (RTD, City, CDOT?): | |
| Pre-Existing RR Agreement with which RR: | | Pre-Existing Agreement RR Lead & Mile Post(s): | | Pre-Existing Agreement Type & Number: | |

| | | |
|---|-----------|-----------------------------------|
| Utility Owner Current (Original): | OH or UG: | Utility Type: |
| Project Location Detailed Description: | | Xing or Parallel or Encroachment: |
| Description of Utility Install Methods: | | |

| | |
|--|--|
| # of Wires, Conduits, Pipes | |
| Carrier Pipe <u>Size</u> -and- Carrier Pipe <u>Thickness</u> : | |
| Carrier Pipe Material: | |
| Encasement Length or Distance between Poles: | |
| Encasement <u>Size</u> - and- Encasement <u>Thickness</u> : | |
| Encasement Material: | |
| Depth Below Base of Rail or Height Above Top of Rail: | |
| Other Important Details (Asbestos, kV, psi, etc): | |
| Variance to RTD Criteria (Explain): | |
| Date to be Installed: | |

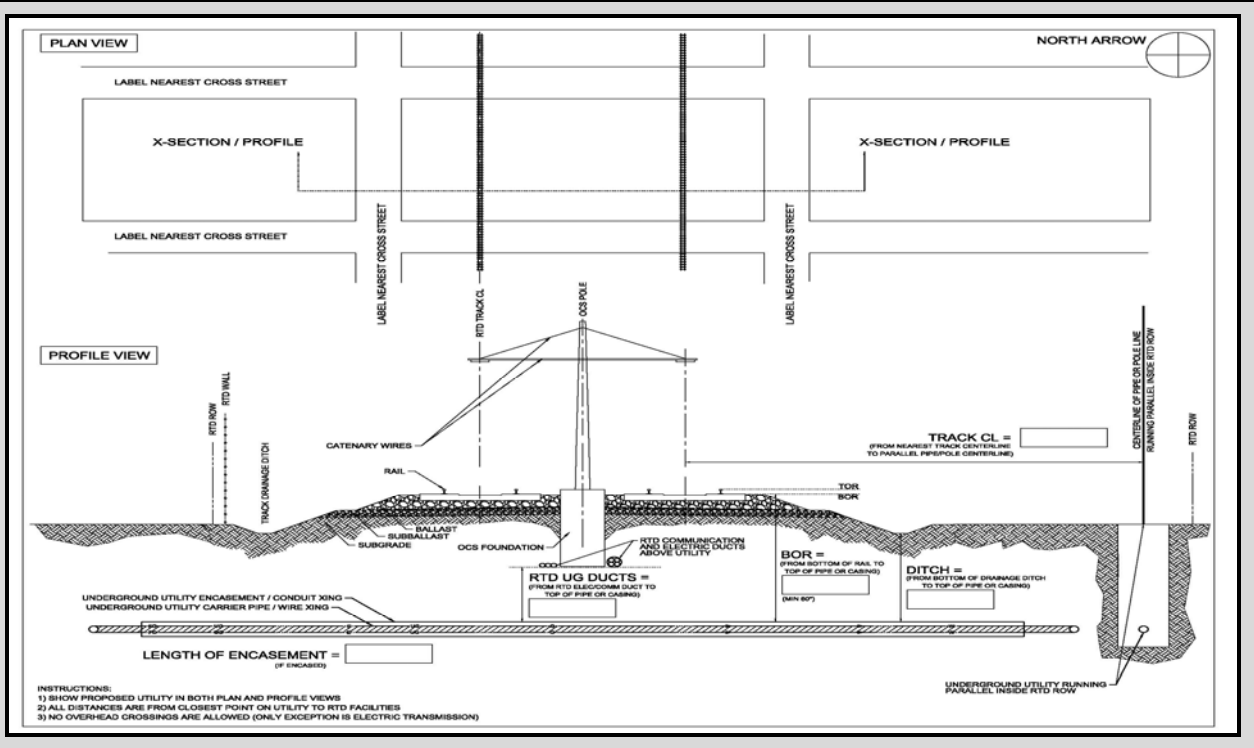

REQUIREMENTS to OFFICIALLY SUBMIT your REQUEST to CROSS RTD TRACKS/ROW to RTD:

- 1) Email Official Requests with the following **Subject Line:**
OFFICIAL REQUEST to CROSS RTD TRACKS/ROW with
{Utility Owner Name} {Size} {Communications, Electric, Gas, Sanitary, or Water} {OH or UG} @ {Street Location} & {Nearest RTD Rail Corridor}
To: RealProperty@rtd-denver.com & Marcia.Fraley@rtd-denver.com // cc: Nikita.Zanichkowsky@rtd-denver.com
- 2) Email Must Include:
 - a - Official Letter requesting permission to cross on official Utility Owner Letterhead (or in body of email with Utility Owner Logo).
 - b - Owner/Developer // Contractor // Who maintains after installation. // Brief Description of Work. // Location of Work (City, Street) // Anticipated Dates of Work.
 - c - Plan/Profile 'For Construction' Plan Set with required RTD Notes to Contractor.
 - d - Completed RTD RR Utility Agreement - Application Data Sheet.
- 3) Contact RTD for the current & updated required [RTD Notes to Contractor](#) and [RTD RR Utility - Application Data Sheet](#).
- 4) Contact RTD's Nikita Zanichkowsky, Utilities (303.299.2420) with Utility Engineering Design Review, Submittal Questions, and updated Notes/Forms. (Over-the-Shoulder Design review with RTD Utility Engineering group is encouraged prior to official request is submitted to RTD Real Property.)
- 5) An Executed RTD Utility License Agreement from RTD's Real Property is required before RTD's MOW/RailOps will Issue a Permit for your work.
- 6) **Contact RTD's Utility Engineering/Construction Team (303-299-2811) a full two (2) weeks prior to construction.**

For RTD Utility Agreement Application Forms and RTD Contact Information, go to www.rtd-denver.com
and enter 'UTILITY' in the searchbar - select 'RTD|Utility Agreements Process'