

Jewell Pedestrian Bridge Install

Project Overview



Tuesday, July 7, 2026

Overview:

The **Regional Transportation District (RTD)**, in close partnership with the **City and County of Denver (CCD)**, will provide bus shuttle service in place of **C Line** trains between **Englewood** and **I-25•Broadway Stations** from **10 p.m. Saturday, July 11**, through **6 a.m. Sunday, July 12**. During this time, CCD crews will install a **new pedestrian and bicycle bridge** over Santa Fe Drive/US 85, the adjacent freight rail corridor, and RTD light rail tracks near West Jewell Avenue, **north of Evans Station**. The new bridge will create **safer, more direct access to RTD's Evans Station** for people walking and biking. Regular service for the C Line will resume **Sunday, July 12 at 6 a.m.**

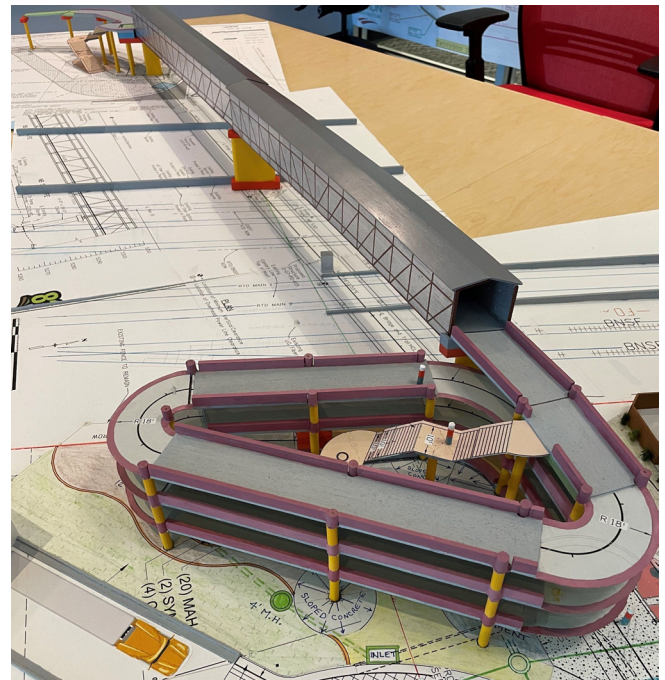

Model of the West Jewell Avenue Pedestrian and Bicycle Bridge. Photo courtesy of City and County of Denver, Department of Transportation and Infrastructure (DOTI)



Safety Moment: *Bridge erection is one of the most hazardous phases of construction, involving heavy lifting, high altitudes, and complex structural dynamics. The highly qualified bridge contractors carefully consider several safety factors including site preparation, fall protection, machinery safety, traffic protection, weather and focused safety checks for each phase.*



Timeline

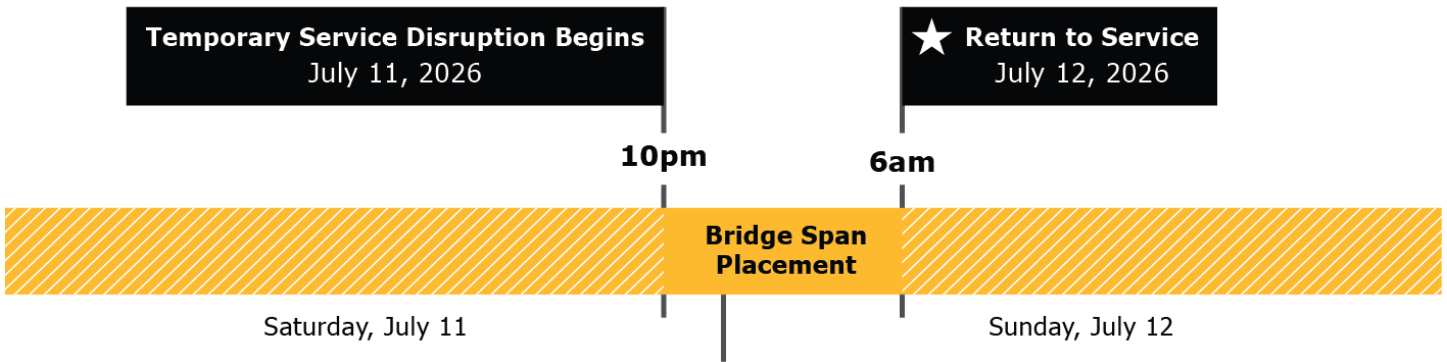

The timeline above provides a breakdown of project milestones. Over the eight-hour service disruption, City and County of Denver (CCD) crews will install the bridge above the RTD light rail tracks. After light rail service is restored, crews will continue bridge installation work over Santa Fe Drive. This timeline reflects extensive joint planning between RTD and CCD to minimize service disruptions while completing a major infrastructure improvement.

Impacts and Alternate Service

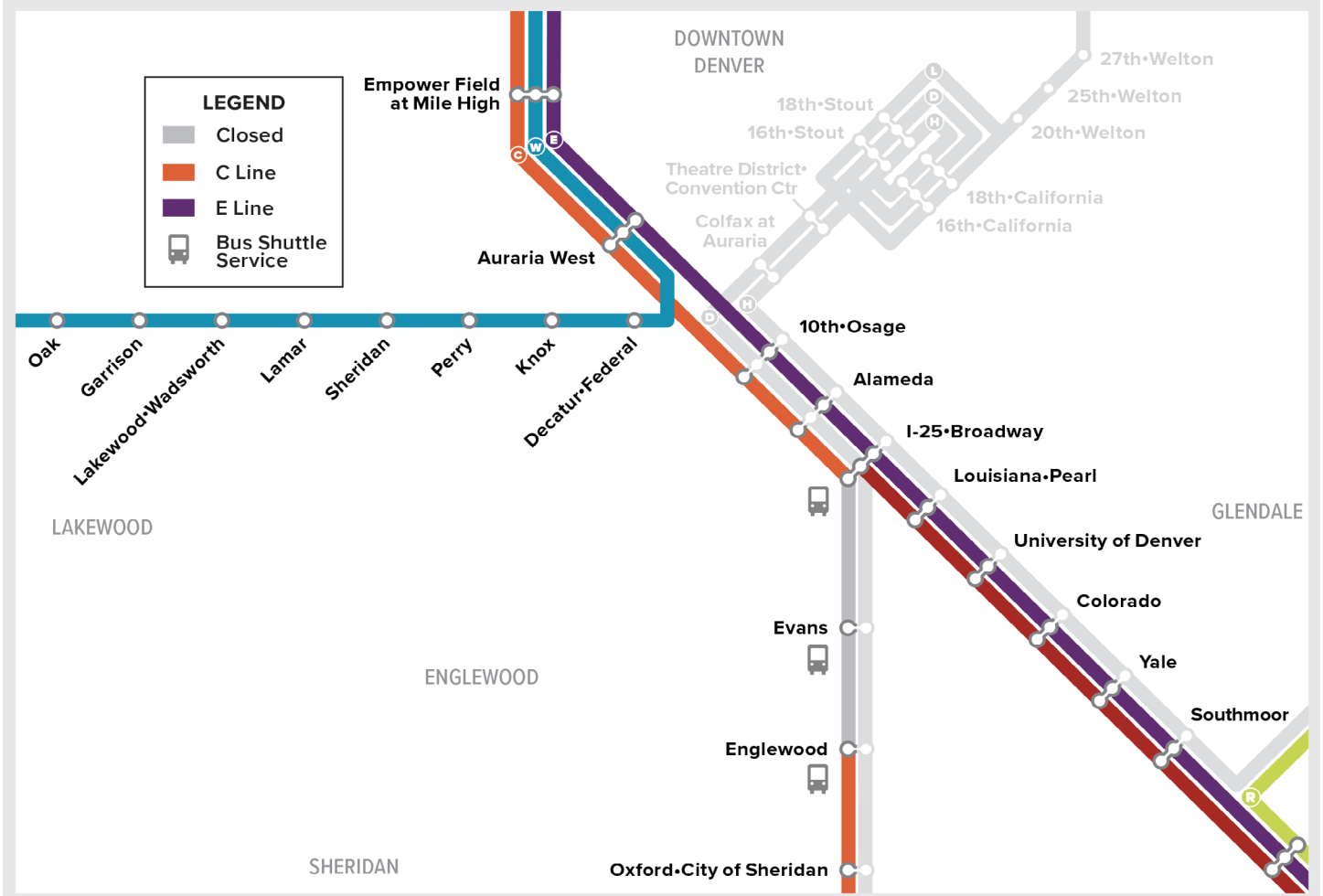

This service map shows light rail and bus shuttle service during the pedestrian bridge installation work. To safely complete the bridge installation, overhead power to the light rail system must be shut down. As a result, C Line rail service will be suspended between the affected stations. Customers can board shuttle buses at the following locations:

- Englewood Station: Gate A
- Evans Station: Gate C
- I-25-Broadway Station: Gate A3

Regular C Line service will continue to operate:

- between I-25-Broadway Station and Union Station
- between Englewood Station and Littleton-Mineral Station

Some early-morning E Line trips will be canceled. Customers should anticipate delays due to the bridge installation and are encouraged to use RTD's [Next Ride](#) web app to plan their trips, view other options and check [Service Alerts](#).

For additional route and schedule information, call RTD Customer Care at 303-299-6000.

Angel Peña and the Engineering Team

Deputy Chief Executive Officer